

**B 51011**

**Snap nuts**

For tapping screw thread DIN EN ISO 1478

Steel | zinc-plated | Cr(VI)-free

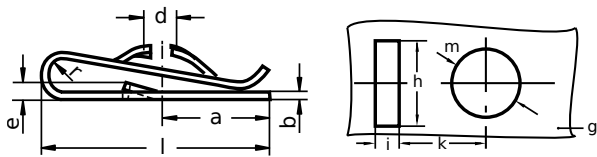

Diameter (d)	a			b			e			g	h		
	nominal size	min.	max.	nominal size	min.	max.	nominal size	max.	min.	nominal size	nominal size	min.	max.
2.9	4.9	4.6	5.2	0.8	0.05	1.10	0.9	1.2	0.6	1.2 - 2.0	8.3	8.05	8.55
3.5	7.9	7.6	8.2	0.8	0.05	0.60	1.4	1.6	1.2	0.7 - 1.6	11.4	11.10	11.70
3.9	7.9	7.7	8.2	0.8	0.05	0.65	1.7	1.8	1.6	0.7 - 1.6	11.4	11.15	11.65
4.2	7.9	7.7	8.1	0.8	0.05	0.65	1.2	1.2	0.9	0.7 - 1.6	12.0	11.70	12.30
4.8	7.0	6.8	7.5	0.8	0.05	1.25	-	-	-	1.5 - 2.8	17.0	16.60	17.40
5.5	12.4	12.1	12.7	0.8	0.05	0.80	2.3	2.6	2.2	0.9 - 2.6	15.0	14.60	15.40
6.5	10.6	8.6	12.6	0.8	0.05	0.75	1.8	2.1	1.5	0.8 - 1.5	16.5	16.10	16.90

Diameter (d)	i	k			m		r			Length (l)		
		nominal size	min.	max.	min.	max.	nominal size	min.	max.	nominal size	min.	max.
2.9	5.5	4.0	3.9	4.1	4.8	5.00	1.1	1.00	1.40	10.7	10.20	11.20
3.5	6.1	6.7	6.5	6.9	6.0	6.20	1.2	1.00	1.40	16.4	16.10	16.70
3.9	7.6	6.7	6.5	6.9	7.2	7.40	1.2	0.95	1.45	16.5	16.25	16.75
4.2	7.6	7.0	6.5	7.5	7.2	7.42	1.1	0.90	1.30	16.5	16.30	17.00
4.8	10.3	9.0	8.8	9.2	7.2	7.40	1.5	1.35	1.65	18.0	17.75	18.25
5.5	9.9	11.1	10.9	11.3	10.0	10.20	2.2	1.90	2.50	26.2	25.70	26.70
6.5	10.0	12.5	12.3	12.7	10.0	10.20	0.75	0.25	1.25	26.0	24.00	28.00

All technical data refer to the measure mm

