

DIN 125 B similar to ISO 7089/7090

Washers

Form B: with chamfer

Steel 140 HV | zinc-plated | Cr(VI)-free

Further information: DIN standard has been withdrawn

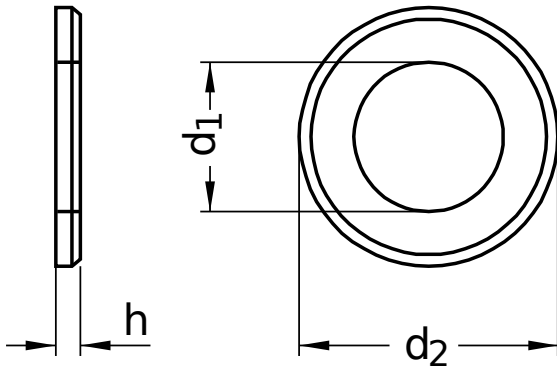

Diameter (d)	d ₁		d ₂		nominal size	h	
	min.	max.	min.	max.		min.	max.
3.2	3.2	3.38	6.64	7	0.5	0.45	0.55
4.3	4.3	4.48	8.64	9	0.8	0.70	0.90
5.3	5.3	5.48	9.64	10	1.0	0.90	1.10
6.4	6.4	6.62	11.57	12	1.6	1.40	1.80
8.4	8.4	8.62	15.57	16	1.6	1.40	1.80
10.5	10.5	10.77	19.48	20	2.0	1.80	2.20
13	13.0	13.27	23.48	24	2.5	2.30	2.70
15	15.0	15.27	27.48	28	2.5	2.30	2.70
17	17.0	17.27	29.48	30	3.0	2.70	3.30
19	19.0	19.33	33.38	34	3.0	2.70	3.30
21	21.0	21.33	36.38	37	3.0	2.70	3.30
23	23.0	23.33	38.38	39	3.0	2.70	3.30
25	25.0	25.33	43.38	44	4.0	3.70	4.30
27	27.0	27.33	49.38	50	4.0	3.70	4.30
28	28.0	28.33	49.38	50	4.0	3.70	4.30
31	31.0	31.39	55.26	56	4.0	3.70	4.30
34	34.0	34.62	58.80	60	5.0	4.40	5.60
37	37.0	37.62	64.80	66	5.0	4.40	5.60
40	40.0	40.62	70.80	72	6.0	5.40	6.60
43	43.0	43.62	76.80	78	7.0	6.00	8.00
46	46.0	46.62	83.60	85	7.0	6.00	8.00
50	50.0	50.62	90.60	92	8.0	7.00	9.00
52	52.0	52.74	90.60	92	8.0	7.00	9.00
58	58.0	58.74	103.60	105	9.0	8.00	10.00
60	60.0	60.74	108.60	110	9.0	8.00	10.00
62	62.0	62.74	108.60	110	9.0	8.00	10.00
66	66.0	66.74	113.60	115	9.0	8.00	10.00
70	70.0	70.74	118.60	120	10.0	9.00	11.00
74	74.0	74.74	123.40	125	10.0	9.00	11.00
78	78.0	78.74	133.40	135	10.0	9.00	11.00
82	82.0	82.87	138.40	140	12.0	10.80	13.20

All technical data refer to the measure mm

