

**DIN 1473** similar to ISO 8740

## Grooved pins

Parallel grooved over full length

Stainless steel 1.4305 | Cr(VI)-free

Further information: DIN standard has been withdrawn

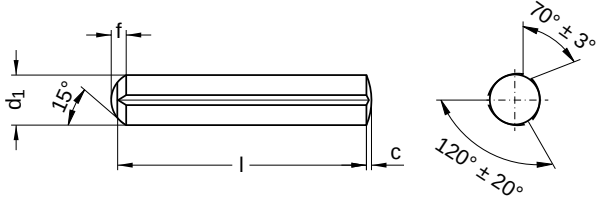

Diameter (d)	c	d <sub>1</sub> nominal size	f
2	0.25	2	0.9
3	0.40	3	1.3
4	0.50	4	1.8
5	0.60	5	2.0
6	0.80	6	2.5
8	1.00	8	2.8

nominal size	Length (l)	
	min.	max.
8	7.71	8.29
10	9.71	10.29
12	11.65	12.35
16	15.65	16.35
18	17.65	18.35
20	19.58	20.42
25	24.58	25.42
30	29.58	30.42

nominal size	Length (l)	
	min.	max.
35	34.50	35.50
40	39.50	40.50
45	44.50	45.50
50	49.50	50.50
60	59.40	60.60

Diameter (d)	Length (l)												
	8	10	12	16	18	20	25	30	35	40	45	50	60
2	●	●	●	●	●	●							
3	●	●	●	●	●	●	●						
4	●	●	●	●	●	●	●	●	●	●			
5	●	●	●	●	●	●	●	●	●	●			
6		●	●	●	●	●	●	●	●	●	●	●	●
8			●	●	●	●	●	●	●	●	●	●	●

• Combinations available in the eShop | Other sizes on request

All technical data refer to the measure mm

