

DIN 6912

Cylinder screws

Hexagon socket with key guide | low head

Steel 08.8 | zinc-plated, thick-film passivated (VZD) | Cr(VI)-free | Metric thread

Further information: Due to their head geometry, these screws are limited in their load bearing capacity, see DIN EN ISO 898-1

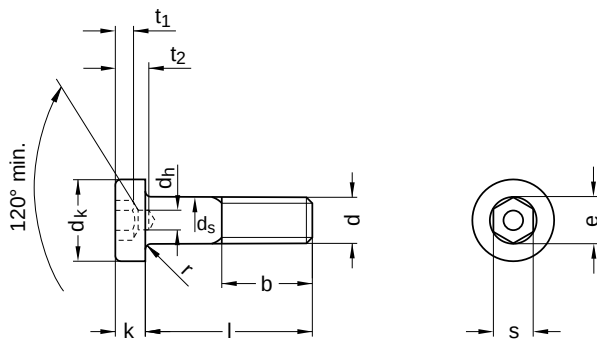

Diameter (d)	b		dh		dk		ds		k		e min.
	l up to 125	l up to 200	min.	max.	min.	max.	min.	max.	min.	max.	
M5	16	–	2.5	2.56	8.28	8.5	4.82	5	3.32	3.5	4.58
M6	18	–	3.0	3.06	9.78	10.0	5.82	6	3.82	4.0	5.72
M8	22	–	4.0	4.08	12.73	13.0	7.78	8	4.82	5.0	6.86
M10	26	32	5.0	5.08	15.73	16.0	9.78	10	6.28	6.5	9.15
M12	30	36	6.0	6.08	17.73	18.0	11.73	12	7.28	7.5	11.43

Diameter (d)	r	s		Pitch (P)	t2		t1		Tool size		
	min.	nominal size	min.		max.	min.	max.	nominal size		max.	min.
M5	0.20	4	4.02	4.12	0.80	4.0	4.30	2.0	2.12	1.88	SW 4
M6	0.25	5	5.02	5.14	1.00	5.0	5.30	2.5	2.62	2.38	SW 5
M8	0.40	6	6.02	6.14	1.25	6.5	6.86	3.0	3.12	2.88	SW 6
M10	0.40	8	8.02	8.18	1.50	7.5	7.86	3.5	3.65	3.35	SW 8
M12	0.60	10	10.02	10.18	1.75	9.0	9.36	4.0	4.15	3.85	SW 10

nominal size	Length (l)	
	min.	max.
2	1.80	2.20
10	9.71	10.29
12	11.65	12.35
16	15.65	16.35
18	17.65	18.35
20	19.58	20.42
25	24.58	25.42
30	29.58	30.42

nominal size	Length (l)	
	min.	max.
35	34.50	35.50
40	39.50	40.50
45	44.50	45.50
50	49.50	50.50
60	59.40	60.60
70	69.40	70.60

All technical data refer to the measure mm



DIN 6912

Cylinder screws

Hexagon socket with key guide | low head

Steel 08.8 | zinc-plated, thick-film passivated (VZD) | Cr(VI)-free | Metric thread

Diameter (d)	Length (l)													
	2	10	12	16	18	20	25	30	35	40	45	50	60	70
M5		●	●	●		●	●		●	●				
M6		●	●		●		●	●	●	●				●
M8	●			●		●	●	●	●	●	●	●	●	
M10				●		●	●	●	●	●	●	●		
M12						●	●	●	●	●	●	●		

- Combinations available in the eShop | Other sizes on request

All technical data refer to the measure mm

