

DIN 7984

Cylinder screws

Hexagon socket | low head

Steel 08.8 | bright | Cr(VI)-free | Metric thread

Further information: Due to their head geometry, these screws are limited in their load bearing capacity, see DIN EN ISO 898-1

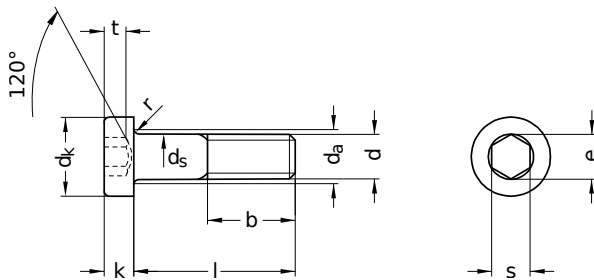

Diameter (d)	b			d _a max.	d _k		d _s		k	
	l up to 125	l up to 200	l longer than 200		min.	max.	min.	max.	min.	max.
M3	12	–	–	3.6	5.32	5.5	2.86	3	1.86	2.0
M4	14	–	–	4.7	6.78	7.0	3.82	4	2.66	2.8
M5	16	–	–	5.7	8.28	8.5	4.82	5	3.32	3.5
M6	18	–	–	6.8	9.78	10.0	5.82	6	3.82	4.0
M8	22	28	–	9.2	12.73	13.0	7.78	8	4.82	5.0
M10	26	32	–	11.2	15.73	16.0	9.78	10	5.82	6.0
M12	30	36	–	13.7	17.73	18.0	11.73	12	6.78	7.0
M16	38	44	57	17.7	23.67	24.0	15.73	16	8.78	9.0
M20	46	52	65	22.4	29.67	30.0	19.67	20	10.73	11.0
M24	54	60	73	26.4	35.61	36.0	23.67	24	12.73	13.0

Diameter (d)	e min.	r min.	s			Pitch (P)	t			Tool size
			nominal size	min.	max.		nominal size	max.	min.	
M3	2.30	0.10	2.0	2.02	2.10	0.50	1.5	1.62	1.38	SW 2
M4	2.87	0.20	2.5	2.52	2.60	0.70	2.3	2.42	2.18	SW 2,5
M5	3.44	0.20	3.0	3.02	3.10	0.80	2.7	2.82	2.58	SW 3
M6	4.58	0.25	4.0	4.02	4.12	1.00	3.0	3.12	2.88	SW 4
M8	5.72	0.40	5.0	5.02	5.12	1.25	3.8	3.95	3.65	SW 5
M10	8.01	0.40	7.0	7.02	7.18	1.50	4.5	4.65	4.35	SW 7
M12	9.15	0.60	8.0	8.02	8.18	1.75	5.0	5.15	4.85	SW 8
M16	13.72	0.60	12.0	12.03	12.21	2.00	5.5	5.65	5.35	SW 12
M20	16.00	0.80	14.0	14.03	14.21	2.50	7.5	7.68	7.32	SW 14
M24	19.44	0.80	17.0	17.05	17.23	3.00	8.0	8.18	7.82	SW 17

All technical data refer to the measure mm



DIN 7984

Cylinder screws

Hexagon socket | low head

Steel 08.8 | bright | Cr(VI)-free | Metric thread

nominal size	Length (l)	
	min.	max.
5	4.76	5.24
6	5.76	6.24
8	7.71	8.29
10	9.71	10.29
12	11.65	12.35
14	13.65	14.35
16	15.65	16.35
18	17.65	18.35

nominal size	Length (l)	
	min.	max.
20	19.58	20.42
22	21.58	22.42
25	24.58	25.42
30	29.58	30.42
35	34.50	35.50
40	39.50	40.50
45	44.50	45.50
50	49.50	50.50

nominal size	Length (l)	
	min.	max.
55	54.40	55.60
60	59.40	60.60
65	64.40	65.60
70	69.40	70.60
80	79.40	80.60
90	89.30	90.70
100	99.30	100.70

Diameter (d)	Length (l)																							
	5	6	8	10	12	14	16	18	20	22	25	30	35	40	45	50	55	60	65	70	80	90	100	
M3	●	●	●	●	●	●	●	●	●															
M4	●	●	●	●	●	●	●	●	●	●	●	●	●	●	●	●	●	●	●	●	●	●	●	●
M5			●	●	●	●	●	●	●	●	●	●	●	●	●	●	●	●	●	●	●	●	●	●
M6			●	●	●	●	●	●	●	●	●	●	●	●	●	●	●	●	●	●	●	●	●	●
M8		●			●	●	●	●	●	●	●	●	●	●	●	●	●	●	●	●	●	●	●	●
M10							●	●	●	●	●	●	●	●	●	●	●	●	●	●	●	●	●	●
M12									●		●	●	●	●	●	●	●	●	●	●	●	●	●	●
M16												●	●	●	●	●	●	●	●	●	●	●	●	●
M20												●	●	●	●	●	●	●	●	●	●	●	●	●
M24														●		●	●	●	●	●	●	●	●	●

• Combinations available in the eShop | Other sizes on request

All technical data refer to the measure mm

