

DIN 988
Shim rings

Spring steel | bright | Cr(VI)-free

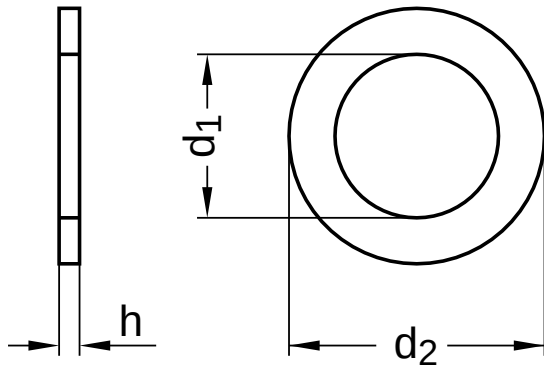

Diameter (d)	d ₁			d ₂			h	
	nominal size	min.	max.	nominal size	min.	max.	min.	max.
7	7	7.04	7.19	13	12.77	12.95	1.15	1.2
8	8	8.04	8.19	14	13.77	13.95	1.15	1.2
12	12	12.05	12.23	18	17.77	17.95	1.15	1.2
14	14	14.05	14.23	20	19.72	19.94	1.45	1.5
15	15	15.05	15.23	21	20.72	20.94	1.45	1.5
16	16	16.05	16.23	22	21.72	21.94	1.45	1.5
17	17	17.05	17.23	24	23.72	23.94	1.45	1.5
19	19	19.06	19.28	26	25.72	25.94	1.45	1.5
20	20	20.06	20.28	28	27.72	27.94	1.95	2.0
22	22	22.06	22.28	32	31.67	31.92	1.95	2.0
25	25	25.06	25.28	35	34.67	34.92	1.95	2.0
26	26	26.06	26.28	37	36.67	36.92	1.95	2.0
28	28	26.06	28.28	40	39.67	39.92	1.95	2.0
30	30	30.06	30.28	42	41.67	41.92	2.45	2.5
35	35	35.08	35.33	45	44.67	44.92	2.45	2.5
				50	49.67	49.92	2.45	2.5
36	36	36.08	36.33	45	44.67	44.92	2.45	2.5
37	37	37.08	37.33	47	46.67	46.92	2.45	2.5
40	40	40.08	40.33	50	49.67	49.92	2.45	2.5
42	42	42.08	42.33	52	51.60	51.90	2.45	2.5
45	45	45.08	45.33	55	54.60	54.90	2.94	3.0
				55	54.60	54.90	–	4.0
50	50	50.08	50.33	62	61.60	61.90	2.94	3.0
55	55	55.10	55.40	68	67.60	67.90	2.94	3.0
56	56	56.10	56.40	70	69.60	69.90	2.94	3.0
60	60	60.10	60.40	75	74.60	74.90	2.94	3.0
63	63	63.10	63.40	80	79.60	79.90	2.94	3.0
70	70	70.10	70.40	90	89.53	89.68	3.44	3.5
80	80	80.10	80.40	100	99.53	99.68	3.42	3.5
95	95	95.12	95.47	115	114.53	114.88	3.42	3.5
110	110	110.12	110.47	140	139.46	139.86	3.42	3.5
140	140	140.14	140.54	170	169.46	169.86	3.42	3.5

All technical data refer to the measure mm

